



The series of automatic and intelligent barrier can be used conveniently and safely added with the humanization clutch device and balance device.

Design and manufactured for high volume vehicle traffic such as : parking lots, toll gates, good yards, railway crossing, commercial premises, building and apartment block access.

Using long life electromechanical gear motors, suitable to carry long hours of operation. The system will be released automatically in case of power failure.

Model :  
RGB-3FD

<b>DURABLE</b>	Each hard material is carefully sorted out and tested by repeatedly compressed, bent for the best performance. The material and its casing can sustain long period of life and resistance to rust.
<b>CONVENIENT &amp; EASY</b>	Convenient to remove, dispose, and maintain. System fully adopts tele-control signal transmitting technique. Plus, it is easy to install.
<b>INTELLIGENT</b>	Automatic checking function ensures immediate operation of the machine whenever power is turn on. Machine ventilation is enhancing by introducing both warm and cold temperature swapping system and longer operation hours.
<b>SECURE</b>	Barrier will automatically reverse when meet obstacle during the process of lifting up and down to prevent accident. Swing away function enables the arm to move back if vehicle hit the barrier arm.
<b>BALANCING</b>	Spring-compression and shake-reduction technology are used to lower the wallop as well as smoothen the machine during operation.
<b>HIGH EFFICIENCY</b>	Easy function of combination automatic and manual opening. The integration of core and machine ensure smooth and proper operation of barrier.

# DIMENSION

## CASING DIMENSION : (ORANGE)

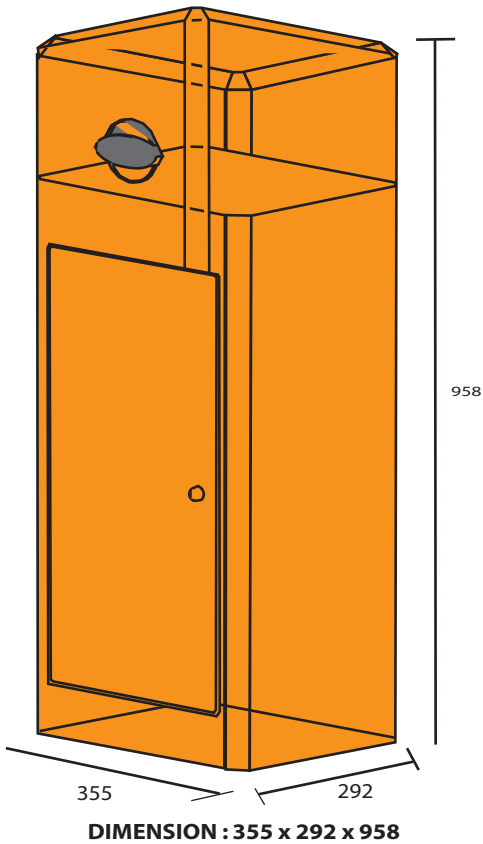

## ARM DIMENSION : OCTAGON / ALUMINIUM / RED REFLECTIVE TAPE / RUBBER(OPTIONAL)

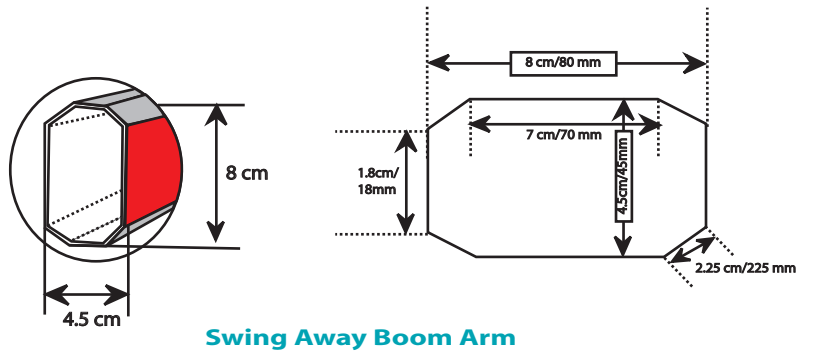
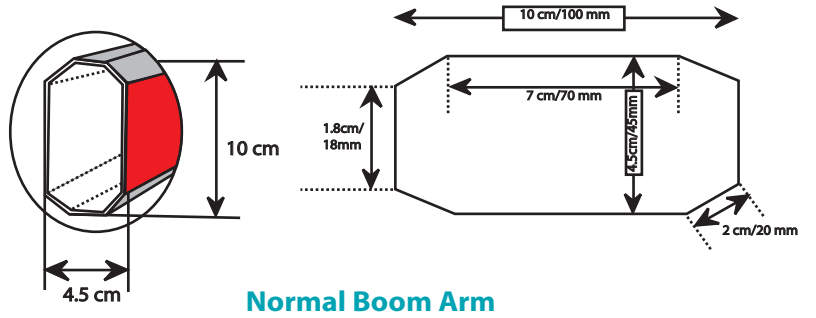

## BASE BARRIER CASING DIMENSION

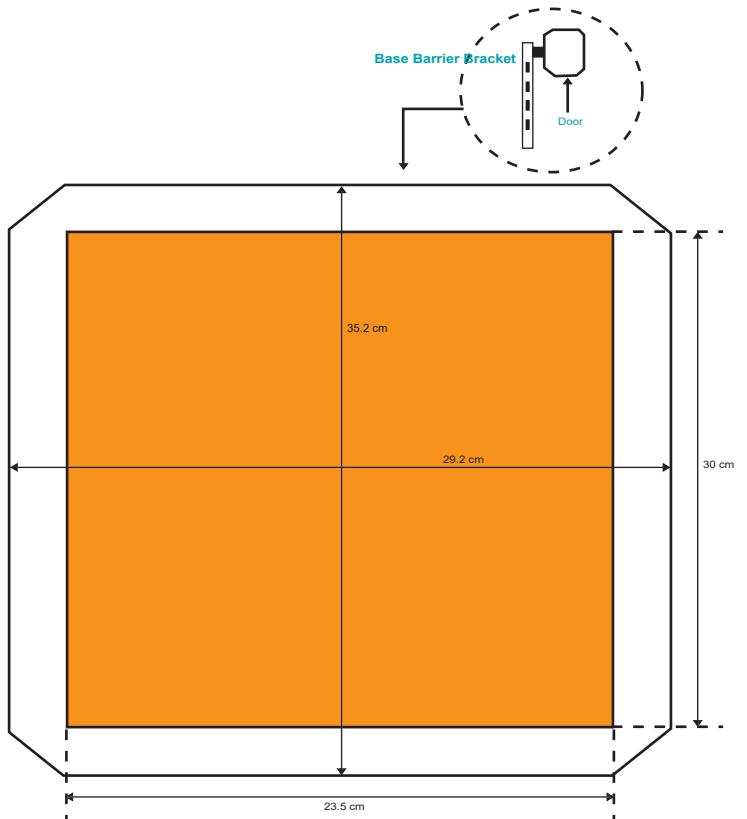
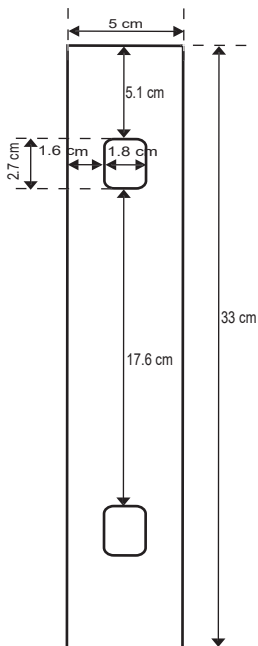

# BARRIER GATE OPERATION SYSTEM

## LEFT (90DEGREE ARM)

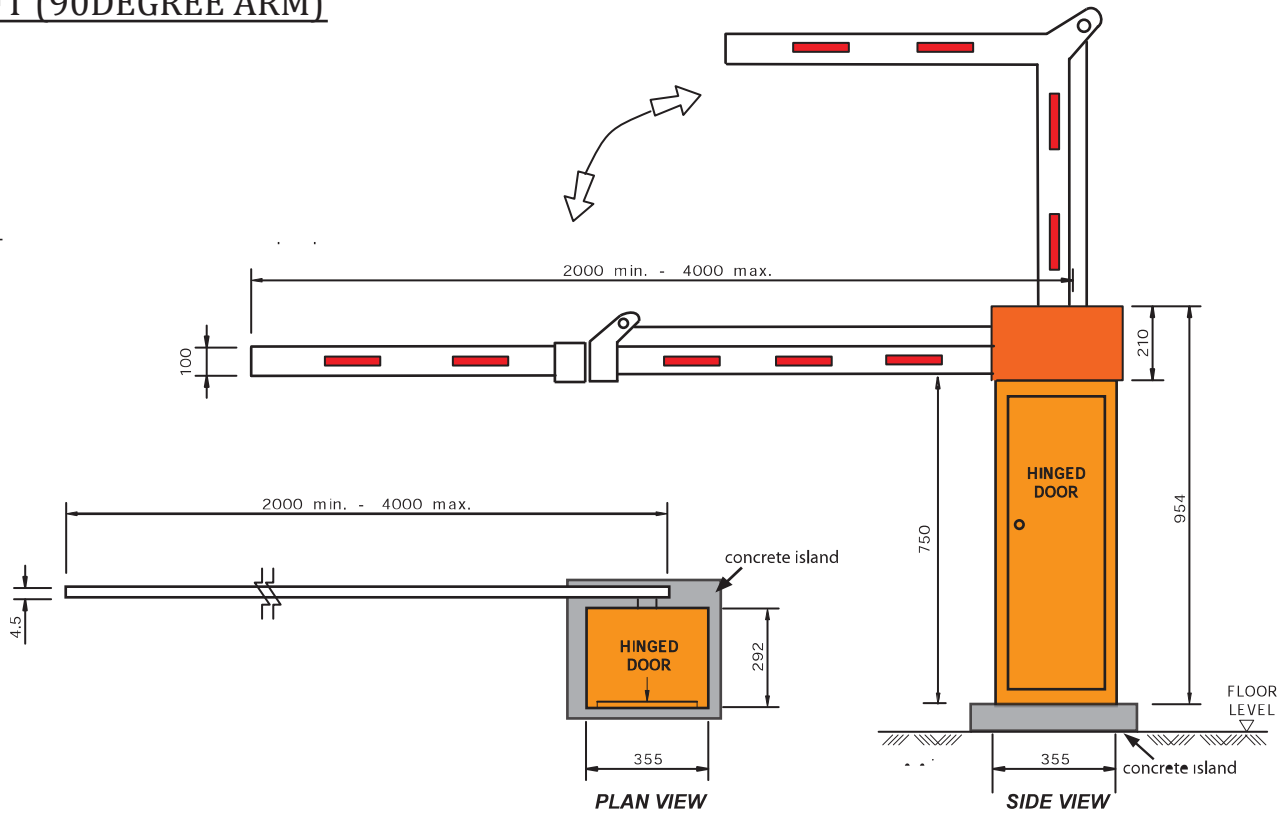

( All dimensions in mm )

## RIGHT (90DEGREE ARM)

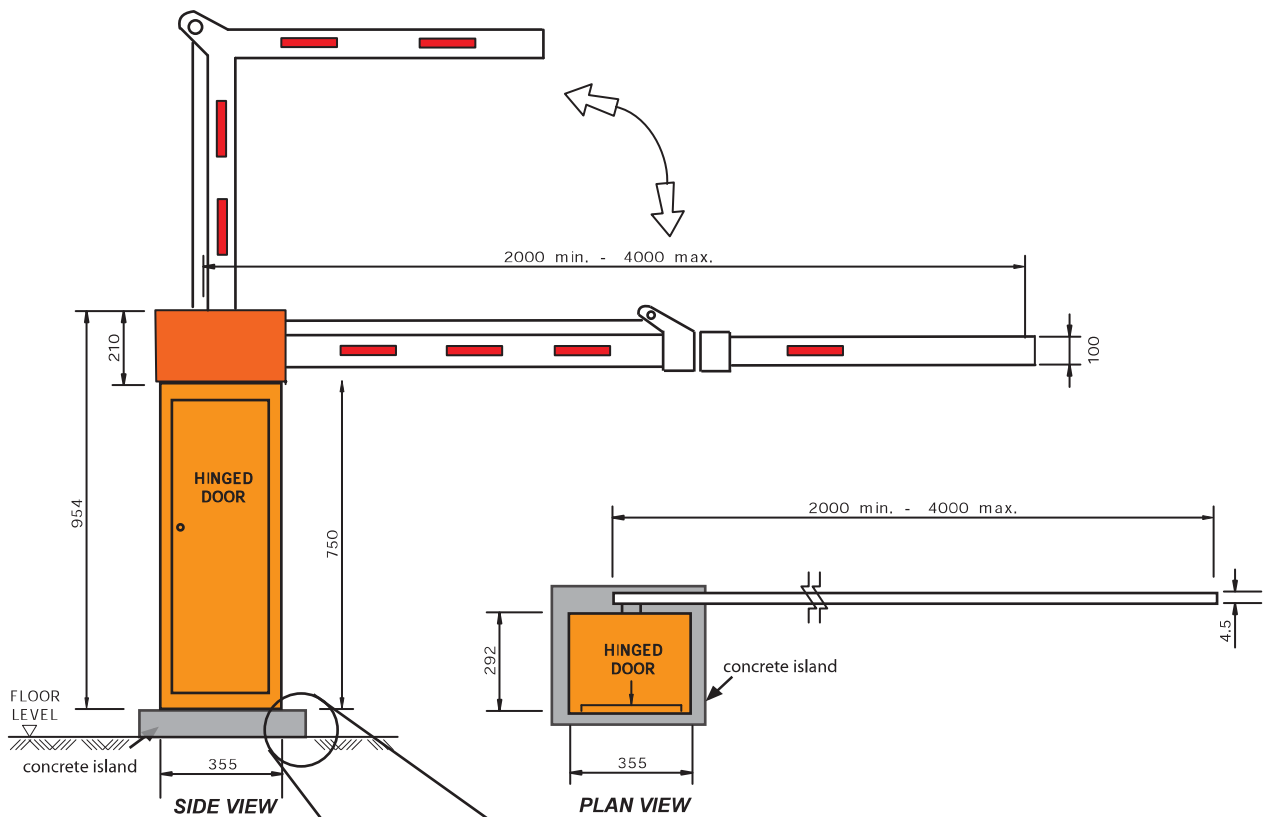

( All dimensions in mm )



# TYPICAL INSTALLATION OF BARRIER GATE SYSTEM

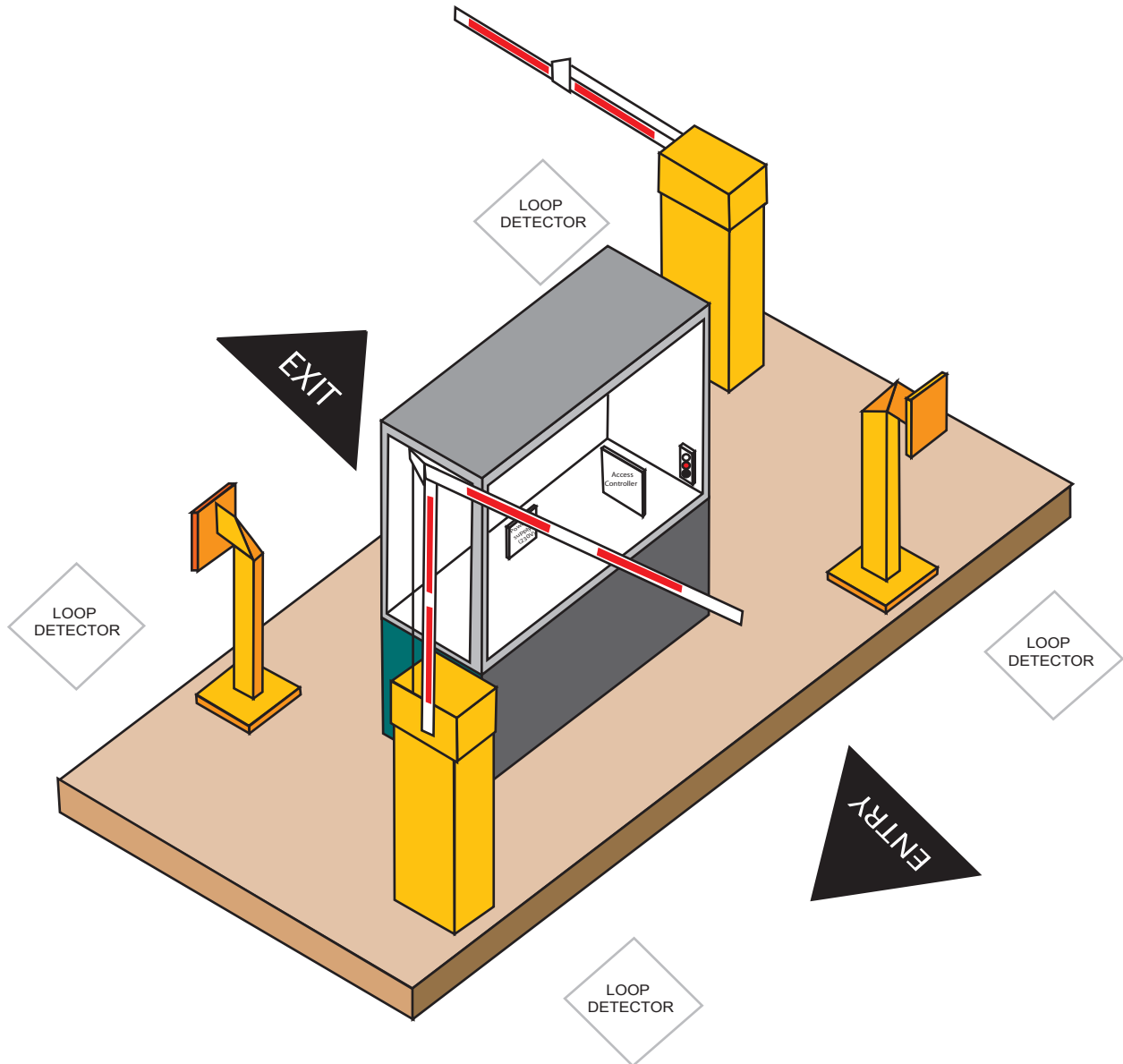

## ACCESSORIES



LOOP COIL



PUSH BUTTON /  
HEAVY DUTY PUSH  
BUTTON



LED TRAFFIC  
LIGHT



LOOP DETECTOR



BEAM SENSOR



SPEED HUMP



PHOTO CELL



WARNING POST



GOOSENECK

# TYPICAL WIRING OF BARRIER GATE SYSTEM

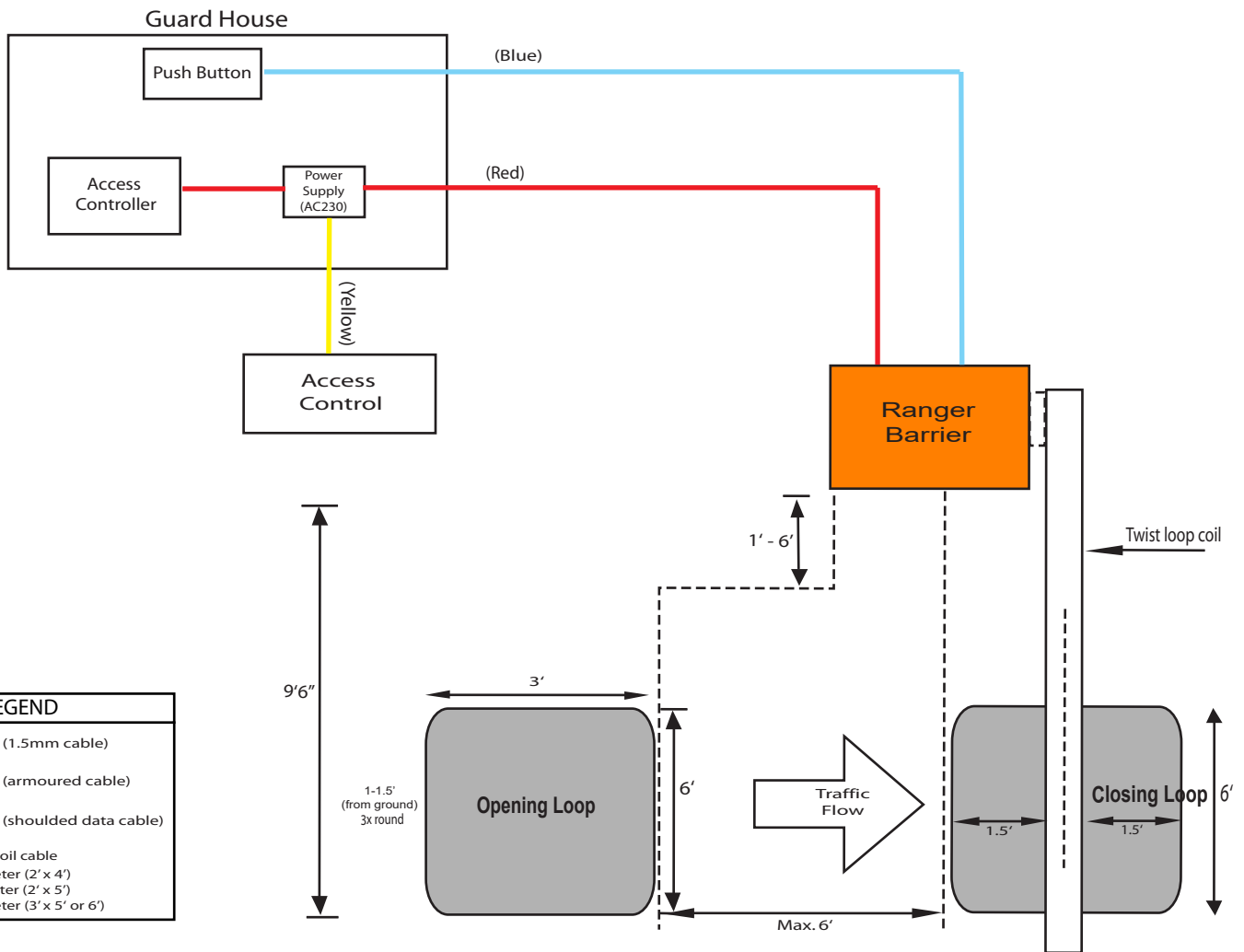

## SPECIFICATION

<b>Supply Voltage</b>	AC 230V
<b>Frequency</b>	50Hz
<b>Motor Rated Power</b>	120W
<b>Power Consumption</b>	80W
<b>Motor Rated Speed</b>	680rpm
<b>Operation Lifespan</b>	>2.5million times
<b>Operation Temperature</b>	-40°C ~ +75°C
<b>Housing Dimension (mm)</b>	355 (L) x 292 (W) x 954 (H)
<b>Weight</b>	60Kg
<b>Standard Color</b>	Orange
<b>Protection Grade</b>	IP44

## ORDERING CODE

Model. No	Open / Close Speed	Max. Arm Length	Type
RGB-3FD	3 sec	upon requested	90°