

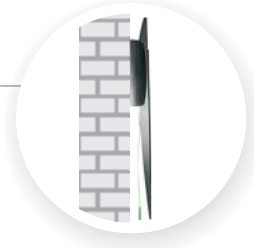

Universal Design
Screen adaptors can be easily hooked onto wall plate for a quick installation.

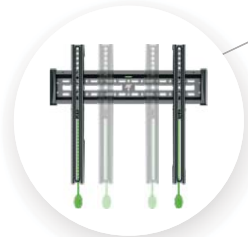

Low Profile Design
Thin flat designed to display your TV as if it is an art, distance from wall 1.2"(29mm).



Horizontal Position Adjustment
Adaptors can be slid easily together with TV within the wall plate to set your position best viewing .

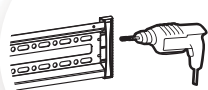

Easy Installation
Easy and quick installation and disassemble. Save two-thirds of installing time than any other universal wall mounts.

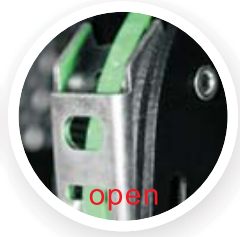

Auto lock and unlock design (Engage and disengage)
Simply holds adaptors and hook onto wall plate and click on. Adaptors will engage and lock onto wall plate automatically. To carry down TV, simply pull adaptors' straps downward to disengage clips and holds it up that's it. No hand tools required, safe, easy and convenient.

SPECIFICATIONS



Model



TV Size



Max Load



VESA(max)



Tilt Angle



Profile From Wall



Material



Mounting Width

NBC3-F	40"-65"	150lbs(68.2kg)	100*100-600*400mm	0°	1.2"(29mm)	SPCC	24"(610mm)
--------	---------	----------------	-------------------	----	------------	------	------------

LINE DIMENSIONS

